

# MONTHLY NEWSLETTER

ISSUE NO.

03

April 2024



## IN THIS ISSUE

02 President's Letter

03 Calendar of Events

04 Coaches

05 Miscellaneous Notes

06 Officer's/Directors/Leads

07 Photos

08 "Woodturners Fear Factor"  
by Lyle Jamieson

# President's Letter

Hi Team,

As we approach Volunteer appreciation week from April 14 to April 20, I would like to extend my heartfelt gratitude to the volunteers who are the backbone of Gold country woodturners. Your dedication and tireless efforts fuel are Club in every aspect.

I wanted to recognize Ridge McGhee our webmaster. On a great job he is doing. Things I appreciate. He double checks information that I sent him for accuracy. He updates and post items on our website on a timely basis.

Always willing to share his thoughts to improve our club. If you haven't been to our website lately, please check it out. Beth Gilliam and her wood gathering team, have harvested a huge number of logs of many different species. Now we just need more time for turning. Beth has been instrumental in working with the Elks to get onsite storage for wood blanks and other equipment.

Congratulations to Teresa Shea. Her logo design was overwhelming picked by the club. Teresa and Mark are working on getting the logo on to t-shirts and polos. More information to come on how to order.

I am proud to be the President of such a group of people, giving of your time and resources. At our last meeting during show and tell. I noticed the whole club was engaged in listening to the presenter of the show and tell item and the fun Bantry back-and-forth. This is what our club is all about family.

Thank you,  
Carlos Angulo

*WIT*  
Women in Turning

**AAW** | AMERICAN ASSOCIATION  
OF WOODTURNERS



# CALENDAR OF EVENTS

## JANUARY EVENTS

- ~~10<sup>th</sup> Zoom board meeting 10am~~
- ~~17<sup>th</sup> Carl Jacobson zoom demo 6pm~~
- ~~24<sup>th</sup> Club meeting 6:30 – 9pm~~  
~~Club demo, Kent & Ridge~~

## FEBRUARY EVENTS

- ~~28<sup>th</sup> Board meeting 5 – 6pm~~
- ~~28<sup>th</sup> Club meeting 6:30 – 9pm~~  
~~Club demo, Bill~~

## MARCH EVENTS

- ~~16<sup>th</sup> Zoom with Kirk DeHeer 9am~~
- ~~27<sup>th</sup> Club meeting 6:30 – 9pm~~  
~~Club demo, Carlos Angulo~~

## APRIL EVENTS

- Sawdust training two-day event*
- 19<sup>th</sup> 9 – 3 demonstration
- 20<sup>th</sup> 9 – 4 all day woodturning class
- 24<sup>th</sup> Club meeting 6:30 - 9pm  
Club demo, Steve Danner

## MAY EVENTS

- 15<sup>th</sup> Club meeting 6:30 – 9pm  
Club demo, any volunteers
- 23<sup>rd</sup> - 25<sup>th</sup> AAW Symposium  
Portland, Oregon

## JUNE EVENTS

- No club meeting
- Sawdust training two-day event*
- 21<sup>st</sup> 9 – 3 demonstration
- 22<sup>nd</sup> 9 – 4 all day woodturning class
- 26<sup>th</sup> **Club Picnic at Western Gateway Park**

## JULY EVENTS

- 13<sup>th</sup> Zoom pro demo Lyle Jamieson,  
10am
- 24<sup>th</sup> Club meeting 6:30 – 9pm  
Club demo, Rich Aeschliman
- Bowl turning for empty bowls and BBQ at Beth Gillian shop TBD*
- Officers & Directors nominated**

## AUGUST EVENTS

- No club meeting**
- Nevada County Fair 7th - 11th**
- 24<sup>th</sup> Members shop tours

## SEPTEMBER EVENTS

- 25<sup>th</sup> Club meeting 6:30 – 9pm  
Club demo Karen Paustell
- Habitat for Humanity fundraiser TBD*
- Officers & Directors listed in newsletter.**

## OCTOBER EVENTS

- 23<sup>rd</sup> Club meeting 6:30 – 9pm  
Club demo Edson Holmes
- Officers & Directors voted on**

## NOVEMBER EVENTS

- No club meeting**
- 9<sup>th</sup> Member shop tours
- Planning meeting for 2025 TBD**
- Officers & Directors start working**

## DECEMBER EVENTS

- 11<sup>th</sup> **Christmas party at the Elks**



## COACHES

Coaches are available, for lessons, problem solving, tool trials, or any other woodturning matter. They love to hear from newbies, experienced turners...the whole lot.

They each have debts to pay from the long-time turners they learned from that they can only take care of by “paying it forward”. Feel free to contact them and set up a time. Coaching is normally done in the coaches shop.

Be a coach/mentor! Few of us learned to become accomplished turners without guidance. Share what you know with those who are eager to learn! If you would like to be added to our list or need more info contact Carlos Angulo

### ***Nevada City***

Bill Juhl 530-263-6602 Bowls, natural edge bowls, harvesting wood, burls, sharpening, tool selection, lathes

### ***Grass Valley***

Carlos Angulo 916-765-8525 Bowls, natural edge bowls

### ***Penn Valley***

Jim Cochrun 530-615-1409 Pens

### ***Grass Valley***

Karl Miller 530-432-2402 Bowls

Club meetings are on the 4th Wed. each month at 6:30pm except August, November and December for our Christmas party. Held at the Elks lodge at 518 CA-49, Nevada City. Meetings are open to all members and our local community.

We are trying something new with Board meetings. Noon time Lunch meeting at a local restaurant is lumberjack in Grass Valley the day before the member meeting. March 26th as always, open to all members. I will send an email when we know the location.

### Club Membership:

As of March 1st 2024 we have 66 active members. Here are 7 great reasons to stay and ask you friends to join.

1. You will miss the smiling faces of your club members.
2. Three pro zoom demo's coming. Kurt DeHeer in March, Lyle, Jamison in July and Stuart Batty in August. All free to members in good standing.
3. Apply for a scholarship enables you to get funding for first time, symposium trip or a two-day training class.
4. Two hands-on sawdust training sessions coming up.
5. Monthly club demo's
6. Fun summer picnic and a wonderful Christmas party.
7. Your membership helps keep our club alive. GCWT Scholarship Program 2024

The club scholarship fund provides grants annually to qualifying members of Gold Country Woodturners to encourage woodturning learning by participation in educational wood turning events, classes and/or symposiums.



## NO COMPUTER

Our club communicates through emails, website, and newsletter. Some of our members do not have computers or use email. If you know of a member that does not have email, ask them to contact me. We can mail the newsletter and other important event info to them. This will help keep everyone connected and informed.

Carlos Angulo  
916-765-8525

## RIDE SHARE

As time go by, we are all getting older. I would like to suggest we start a ride share program to help members get to the many events we provide. Some don't like to drive at night or in the rain or they can't anymore for whatever reason. If you need a ride or would like to help, please contact

Carlos Angulo  
916-765-8525

## LEARN TO TURN YOUTH PROGRAM



Photo: Andi Wolfe

In the tradeshow again this year, we'll offer special hands-on turning classes free of charge to youth ages 10-18 (with a registered Symposium attendee). Register your youth attendee at [aawsymposium.org](http://aawsymposium.org).

If space allows, classes will open to new turners of any age, so if you, a spouse, or friend are interested, stop by the Learn to Turn area in the tradeshow to check availability.

Learn to Turn Youth instructors include Preston Christensen, Ron Day, Raleigh Lockhart, and Paul Otterstrom.

Youth registered in the program will have a chance to win a lathe package.

Youth Classes include a variety of fun projects:

- Ice Cream Scoop
- Ball & Cup Game
- Turning Apples
- Turning a Leaf Bowl
- Twist Pen
- Screwdriver
- Tea Lights
- Turning a Pear

Our heartfelt thanks to the businesses and individuals who generously donated tools and materials in support of the AAW Youth Program.



---

## 2024 OFFICERS & DIRECTORS

President: Carlos Angulo  
Vice President: Kent Kellegrew  
Treasurer: Rick Panos  
Secretary: Edson Holmes

### DIRECTORS

Peter Voske  
Ed Larson  
Hank Wikstad  
Rick Aeschliman  
Beth Gilliam

---

### SPECIAL ACTIVITY LEADS

**Membership & Roster:** Nancy Bynes

**Web Master:** Ridge McGhee

**Wood Raffle:** Kenny Frerichs

**Cookies:** Karin Paustell

**Coffee:** Don Ferguson

**Photos:** Dave Nelson

**Fair Coordinator:** Peter Voske

**Scholarship Chair:** Rick Panos

**Scholarship Team:** Edson Holmes  
Carl Van Son  
Carlos Angulo

**Audio:** Mark Mixson

**Video:** Don Anderson/Mike Selser

**Newsletter/Social Media:** Marco Del Rio

**Elks Club Member:** Karl Miller  
Beth Gilliam

**Zoom Coordinator:** Edson Holmes

**Christmas Party Coordinator:**  
Kent Kellegrew

**Empty Bowls:** Patrick Speer

**Picnic Coordinator:** Kent Kellegrew

**Flyer for Demo's:** Randy Panos

**Tool & Trailer Coordinator:** *Open*

**WIT Liaison:** *Open*

**Wood Gathering Chair:** Beth Gilliam

**Wood Gathering Team:**  
Edson Holmes  
Peter Voske  
Brad Peceimer-Glasses  
Robert Castlebary  
Rick Aeschliman  
Ridge McGhee  
Patrick Speer

**Fundraiser (New):** *Open*



“Get your photos added to newsletter by emailing them to [marco.delrio@gmail.com](mailto:marco.delrio@gmail.com)

The newsletter articles and photos are due by 2nd Tuesday of every month.”

Marco Del Rio



Can't Make it to Portland?  
**WATCH FROM HOME!**



20

Demonstrations Live-Streamed, Recorded, & Available to Watch Later



REGISTER FOR THE VIRTUAL SYMPOSIUM AT [AAWSYMPOSIUM.ORG](http://AAWSYMPOSIUM.ORG)



# Small Lidded Bowl



Bowl with lid,  
2009, Pear, walnut,  
3¼" x 3"  
(80mm x 75mm)

Bruce Thompson

A fun project to make is a small bowl with a handled lid. In this example, the lid continues the curve of the bowl and ties the piece together. The handle is in harmony with the gentle curve of the lid. There are three stages to this project: the lid, the bowl, and the handle. Turn the lid first so that you can shape the bowl and lid together.

I used pear wood for the bowl and lid, and walnut for the base and handle. Pear is a beautiful wood for turning; it is clear and tight grained, and finishes well. It is important to use

dry wood when turning lidded bowls or the finished piece will warp and the lid will no longer fit properly.

## Making the lid

Cut a piece of wood for the lid that is 3" (75mm) diameter by ¾" (20mm) thick. To prepare it for mounting on an arbor screw chuck, locate the center and drill a ⅜" (5mm) hole (or whatever size is suitable for your chuck) all the way through. Mount the wood on the arbor screw chuck so that the inside surface of the lid is available for cutting.

Smooth the face of the blank and then use dividers to mark a circle 2¼" (55mm) in diameter for the tenon of the lid. Use a parting tool to cut on the outside of the line, into the lid about ⅛" (3mm) deep. There should be about ⅜" (10mm) from the tenon edge to the outside diameter of the lid. Later, as you shape the lid and bowl together, this distance will be reduced to about ¼" (5mm). The tenon should have a finished profile about ⅛" (3mm) high by ⅛" (3mm) thick.

Start cutting the inside dome of the lid. Cut in small arcs, increasing the diameter as the depth increases. Take care when you get to the depth where the screw begins to be visible (*Photo 1*). Take light cuts so that your gouge doesn't nick the screw. The last cut should start at a diameter of 2" (50mm) and should be about ½" (13mm) deep. Make the inside profile a smooth arc. When finished turning the inside of the lid, sand that area.

Make a spacer to fit on the arbor screw chuck out of a scrap of wood. Turn a dome-shaped profile to match ▶

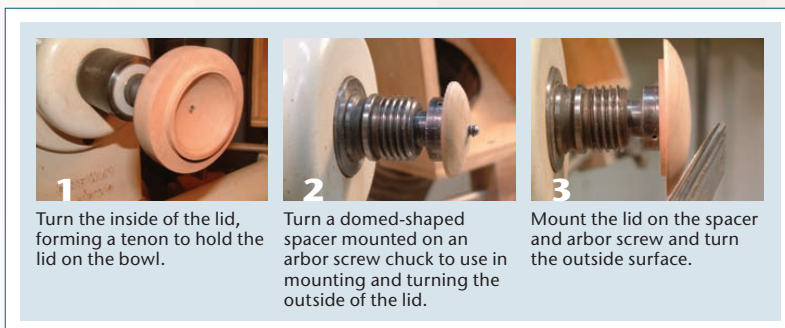

1 Turn the inside of the lid, forming a tenon to hold the lid on the bowl.

2 Turn a domed-shaped spacer mounted on an arbor screw chuck to use in mounting and turning the outside of the lid.

3 Mount the lid on the spacer and arbor screw and turn the outside surface.







**4** With the bowl blank mounted on a screw chuck, turn the bowl and base sections round, cut a tenon for remounting the blank, and mark the center of the tenon.



**5** Begin to shape the bowl and base, leaving the tenon intact for remounting.



**6** Reverse the bowl into a four-jaw chuck using the tenon formed on the base.

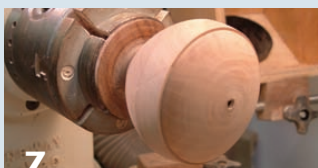

**7** The lid should be held tightly enough on the bowl so that it can be shaped and blended with the bowl.



**8** Blend the lid and bowl shapes together.



**9** Hollow the interior of the bowl and check the depth.

the inside of the lid, making the thickness of the spacer equal to the length of the arbor screw minus the desired  $\frac{1}{8}$ " (3mm) thickness of the lid (*Photo 2*). The protruding end of the screw will thus correspond to the correct thickness for the finished lid. Remount the lid on the arbor screw chuck over the spacer and turn the outside surface of the lid (*Photo 3*). Stop when the tip of the screw is exposed. Sand.

### Making the bowl

Cut a piece of wood  $3\frac{1}{4}$ " (85mm) diameter by 2" (50mm) thick for the bowl and a contrasting piece of wood  $2\frac{1}{2}$ " (65mm) diameter by  $\frac{3}{4}$ " (20mm) thick for the base. Glue them together, taking care to align the grain running in the same direction.

In the wood that will become the inside of the bowl, drill a  $\frac{7}{64}$ " (7mm) hole in the center about 1" (25mm) deep. (Or drill whatever size hole is suitable for your 3" [75mm] screw chuck.)

Mount the bowl blank on the screw chuck and turn the two sections to cylinders. Make the bowl's diameter close to  $3\frac{1}{8}$ " (80mm) and that of the base about  $2\frac{1}{2}$ " (65mm). Use dividers to mark a tenon for holding in a four-jaw chuck (approximately 2" [50mm] in diameter) and cut in with a parting tool about  $\frac{1}{4}$ " (6mm) deep. Leave a shoulder for the tenon for squaring against the top of the jaws of the chuck—this shoulder is the most important part of making a tenon fit securely into a chuck. Before going to the next step, mark a dimple in the center of the bottom of the tenon for a later operation to finish the base (*Photo 4*).

Try to envisage the final shape of the bowl. In this case, think of the most pleasing apple shape you have ever seen. Locate the largest diameter of the bowl about  $\frac{2}{3}$  up from the bottom of the finished piece. Reduce the diameter of the base above the shoulder of the tenon to about

$1\frac{1}{2}$ " (40mm). Start shaping the bowl, cutting from the small diameter to the largest diameter, aiming for a smooth curve (*Photo 5*).

Remove the bowl blank from the screw chuck and mount the tenon in a four-jaw chuck, keeping the shoulder tight against the top surface of the jaws (*Photo 6*).

### Shaping the bowl to fit the lid

Smooth the flat top of the bowl and use dividers to mark a circle  $2\frac{1}{4}$ " (55mm) in diameter where the tenon of the lid will fit. Cut on the inside edge of the circle with a parting tool. It is important to get an interference fit (press fit). The lid should need some force to be pushed into place but not too much; otherwise it might split (*Photo 7*). The lid should not fly off when the lathe is turned on. A helpful hint is to taper the opening as you cut it; then, as the lid starts to fit, straighten the sides of the walls. If you happen to get the opening too large, simply make the bowl a little shallower and start again.

With the lid in place, start shaping the outside of the bowl, blending the curve of the lid with the sides of the bowl (*Photo 8*). To make the cleanest cut possible, cut from the smallest diameter toward the largest. Sand the outside of the lid and bowl.

Remove the tight-fitting lid by inserting the screw of the arbor screw chuck into the hole in the lid. Very carefully pry the arbor and sharply rap with your knuckle on the lid. It should start to separate from the bowl. Rotate and repeat on the opposite side until the lid has separated. Once the lid is off, enlarge the opening very slightly to get a loose fit for the lid. Make the fit looser than you might think you need to, because the wood will seasonally warp and the finish will shrink the fit.

Hollow the interior of the bowl (Photo 9) and sand it. Apply sanding sealer to the inside surfaces of the lid and bowl. Lightly sand the inside again and, with the lathe off, wipe polyurethane on these surfaces. Use a clean paper towel to remove any excess polyurethane. (You will apply finish to the exterior of the bowl, lid, and handle when all three parts are finished.)

**Turning the bottom of the bowl**

Remove the bowl and the chuck from the lathe. Mount a scrap piece of wood 3" (75mm) in diameter between centers and turn a 2¼" (55mm) tenon on one face (Photo 10). You will use this tenon to mount the scrap piece of wood into your four-jaw chuck. This scrap piece of wood will then be used to hold your bowl for turning the bottom.

Remove the wood and the drive center from the lathe, remount your four-jaw chuck, and mount the scrap wood in the chuck. Form a tenon on the outer face of the scrap block and size it to fit into the opening of the bowl (Photo 11). This will allow you to reverse and center the bowl on the lathe.

Mount the bowl on the scrap-wood tenon and bring the tailstock up to fit into the dimple in the bottom of the tenon on the bowl's base. Establish the bottom of the bowl and blend the base into the curve of the side of the bowl (Photo 12).

Reduce the diameter of the excess wood until only a small nub is attached to the bowl at the tailstock (Photo 13). Sand. Remove the bowl from the lathe and cut the nub away with a knife. Sand that area if needed.

**Making the handle**

Many styles of handles might be appropriate for this project, but a carved one adds a special character to the finished piece.

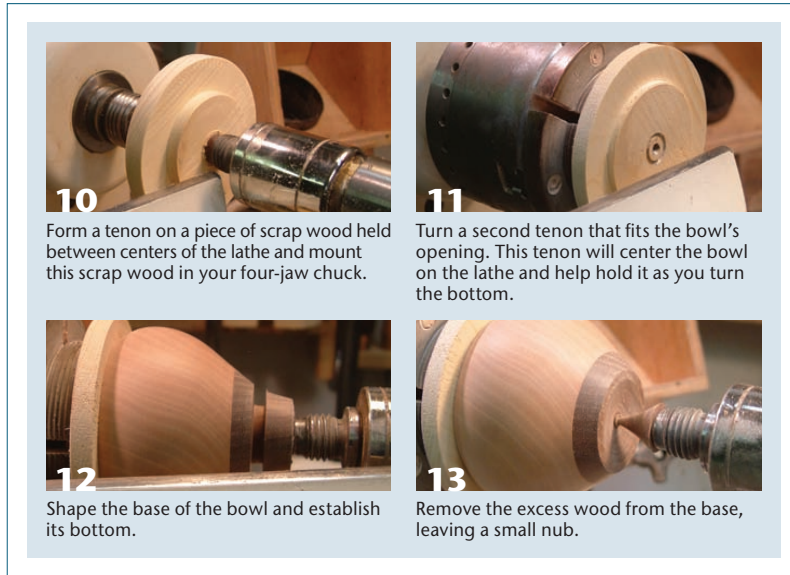

**10** Form a tenon on a piece of scrap wood held between centers of the lathe and mount this scrap wood in your four-jaw chuck.

**11** Turn a second tenon that fits the bowl's opening. This tenon will center the bowl on the lathe and help hold it as you turn the bottom.

**12** Shape the base of the bowl and establish its bottom.

**13** Remove the excess wood from the base, leaving a small nub.

Cut a blank from 5/16" (8mm) stock such that neither the arc nor the stem of the handle aligns with the grain (Photo 14).

Drill down into the stem of the handle with a ¼" (6mm) tenon-forming bit (Photo 15). The stem formed will fit perfectly after the hole drilled in the lid is enlarged slightly. To do so, drill the hole in the lid from the inside out with a ¼" (6mm) drill bit.

I used a Dremel rotary tool with a cylindrical double-cut bit to shape the handle (Photo 16). Sand the handle after shaping it. Hint: make the handle longer than needed and then

cut it to suit the piece after it's shaped. Glue the handle in place.

**Finishing the bowl**

The pear and walnut combination looks good with one or two coats of Danish natural oil. This darkens the walnut and warms or brings out a pink color in the pear. Let the oil dry thoroughly for a few days, lightly smooth the surface with 0000 steel wool, and, as a final finish, apply two coats of high-gloss polyurethane finish. ■

*Bruce Thompson is a member of the Minnesota Woodturners Association.*

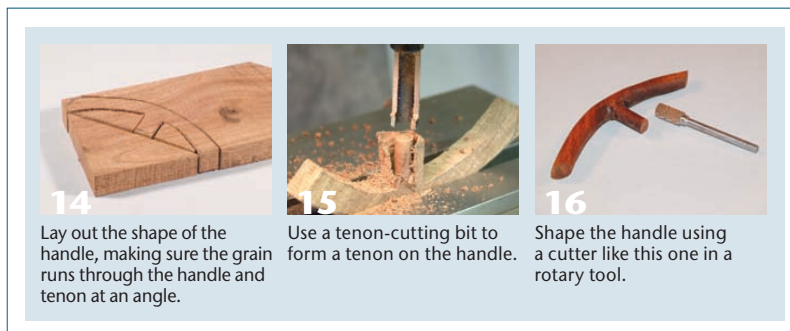

**14** Lay out the shape of the handle, making sure the grain runs through the handle and tenon at an angle.

**15** Use a tenon-cutting bit to form a tenon on the handle.

**16** Shape the handle using a cutter like this one in a rotary tool.

